

Passions and Pathways Industry Visits – 2018



Company: Dennis Family Homes

Type of Industry: Construction

Location of visit: Residential (house) construction site.

HEALTH AND SAFETY

Pre-visit 'Health and Safety' training to be provided to the group by Safety Systems (Paul Flood)
Induction – Emergency Management
Risk Assessment – completed by school

PERSONAL PROTECTIVE EQUIPMENT

All students to be dressed in fluoro jackets, helmets and solid shoes prior to entering the site. Fluoro jackets provided by school / industry

SCOPE OF VISIT

The visit is to provide 2 groups of Grade 6 students (approx. 10-12 per group) with a visual experience in observing a house under construction (hopefully with a few trade workers on-site) as well as an explanation of the different phases of a house under construction and the relevant trade workers for each of these phases.

For each of the phases, simple explanations need to be provided. These explanations may result from asking the group a leading question (or two) such as 'why is it important to get the level of the foundation and measurements accurate?'



PHASES OF CONSTRUCTING A HOUSE



THIS PROTECTIVE EQUIPMENT
MUST BE WORN
IN THIS AREA

ENTERING A HOUSE CONSTRUCTION SITE

– induction re safety requirements



HOUSE DESIGN

– establishing a house plan and location.
Simple explanation of what Dennis Homes undertakes for a client.



PREPARING A SITE AND CONSTRUCTING THE HOUSE FOUNDATION

– simple explanation of each type of foundation. Key elements include soil tests, the importance of having the measurements precise – use of laser equipment, location of services, etc.
Explain why having any errors at this stage are catastrophic.



WALLS AND ROOF - SIMPLE EXPLANATION OF THE VARIOUS COMBINATIONS OF WALLS AND TYPE OF ROOF MATERIAL

– ie what is a brick veneer house, solid brick house, Weatherboard house. Use of insulation – why?



PROVISION OF SERVICES

– planning for and installation of infrastructure for water, waste water / sewer services, electricity, gas and communications services



FIT-OUT

– windows, bathroom, kitchen etc.

Note: During each phase of construction, the different types of trades workers and service providers that would be involved would be included.

Potential career pathways may include:

- Surveyor
- Architect
- Draftsperson
- Plant Operator
- Carpenter
- Concretor
- Bricklayer
- Plumber
- Electrician
- Painter
- Plasterer
- Cabinet Maker / Joiner
- Building Contractor

Example of House plan

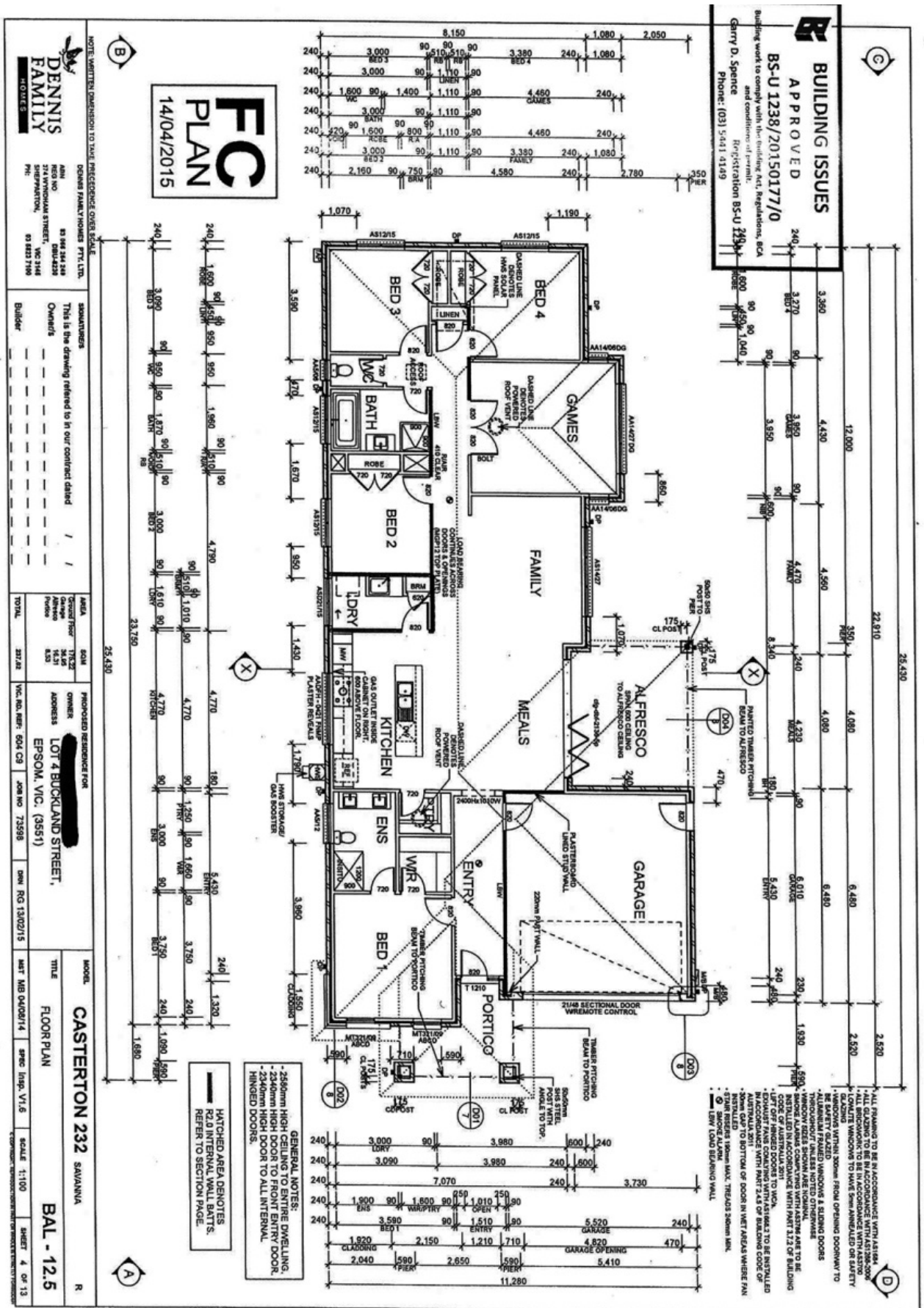

SOME QUESTIONS THAT MAY BE ASKED BY STUDENTS:

- *How long does it take to build a house?*
- *How many houses are being built in Bendigo annually? Answer: Approx. 1,100*
- *What is the average size of a house?*
- *How much does it cost to build an average-sized house?*
- *Who are the most important workers on-site?*
- *Where and what training do apprentices undertake?*
- *How much money does a tradesman earn?*